

Godwin Associates P.A.  
 Godwin Associates P.A.  
 Godwin Associates P.A.  
 Godwin Associates P.A.  
 Godwin Associates P.A.  
 Godwin Associates P.A.  
 Godwin Associates P.A.

Architects / Planners

505 N. Church St. / Charlotte, NC 28202  
 Tel (704) 377-4051 \* Fax (704) 377-4053  
 email to: george@godwinassociates.com

**SCOPE DOCUMENT:**  
 THIS PRELIMINARY DRAWING INDICATES THE GENERAL SCOPE OF THE PROJECT IN TERMS OF ARCHITECTURAL DESIGN CONCEPT, THE DIMENSIONS OF THE BUILDING, THE MAJOR ARCHITECTURAL ELEMENTS AND THE TYPE OF STRUCTURAL, MECHANICAL, ELECTRICAL SYSTEMS. AS SCOPE DOCUMENTS, THE DRAWINGS DO NOT NECESSARILY INDICATE OR DESCRIBE ALL WORK REQUIRED FOR FULL PERFORMANCE AND COMPLETION OF THE REQUIREMENTS OF THE CONTRACT DOCUMENTS. ON THE BASIS OF THE GENERAL SCOPE INDICATED OR DESCRIBED, THE PROPER EXECUTION AND COMPLETION OF THE WORK, DECISIONS OF THE ARCHITECT AS TO THE ITEMS OF WORK INCLUDED WITHIN THE SCOPE OF THIS DOCUMENT SHALL BE FINAL AND BINDING ON THE CONTRACTOR AND THE OWNER.

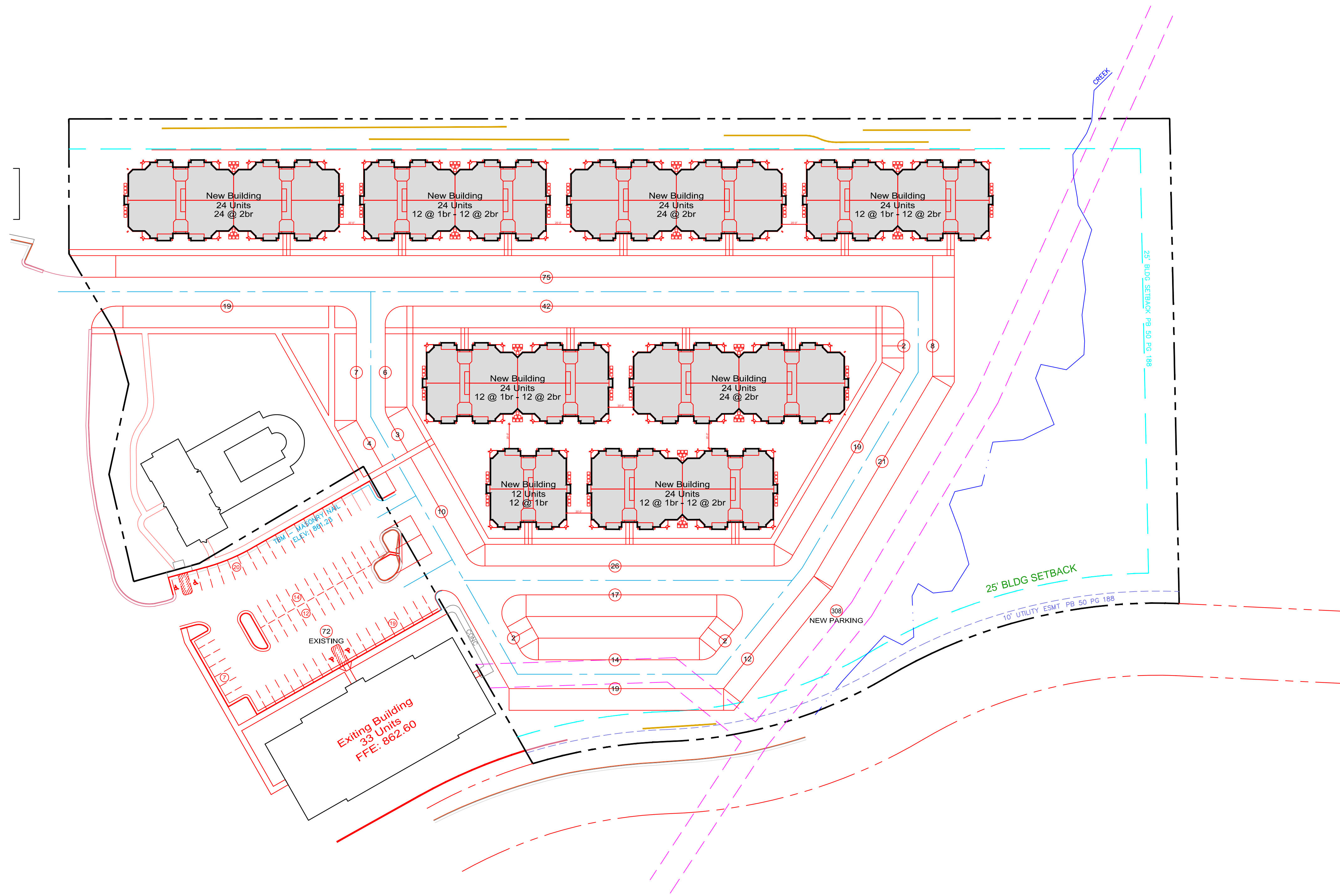

# Heritage Park

Apartment Homes at South Park Blvd.  
 Winston Salem, North Carolina

Project Number: 00000  
 Sheet Title:

**EAST SITE PLAN**  
**Concept 01b**

**1 & 2 Bdrm Units**  
**213 Units Total**

DRAWN BY: SLJ  
 DATE: 03.21.2013  
 REVISIONS:

**AS01b**

Copyright by Godwin Associates, P.A.

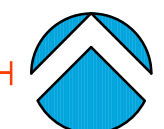
PLAN NORTH  01  
 60 New One Bedroom Units -- 120 New Two Bedroom Units  
**EAST SITE PLAN -- 33 Existing Units + 180 New Living Units = 213 Total**  
 1" = 100'  
 72 Existing Parking + 308 New Parking = 380 Parking Spaces Total (1.78 sp / unit -- Average)